



DALAL **FLAT PACK** MODULAR UNITS



TECHNICAL SPECIFICATIONS

MATERIAL

- Floor** Main and Secondary Galvanized steel framing.
Marine Plywood with PVC for dry areas and Cement Board with welded PVC for wet areas.
- Roof** Main and Secondary Galvanized steel framing Pre painted steel false ceiling.
Fiberglass Insulation covered with seamed steel sheets.
- Walls** Sandwich Panels W: 116 cm / H : 250 cm / T: 5 cm.
- Doors** Galvanized Steel Frame / Leaf: Made of 2 layers of galvanized steel injected polyurethane / Rubber sealant + door stopper Handle with standard lock.
- Windows** Aluminum Profile Sliding / Hinged / Fixed / Color: White
Single Glazed 6mm / Fly screen and Steel Bars.
- Electrical Works** Each Unit will be supplied by Main Panel Board / Fluorescent lighting / switches / Electrical sockets.



Flat packed

Transportation of units is %75 more efficient than a standard converted container.

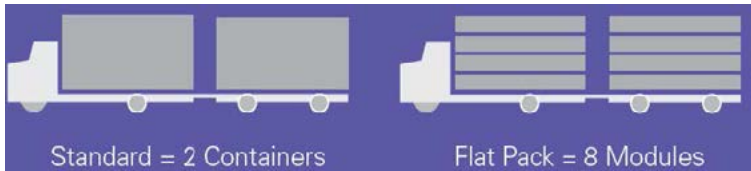

Mobile

Single modules can easily be moved, once on site, using a forklift or sliding crane. A standard Unit has a weight of 2 Tons.

Durable

The modular frame is manufactured from galvanized cold formed steel resulting, in reduced weight and increase strength.

Flexible floor plan designs

The modular frame is manufactured from galvanized cold formed steel resulting, in reduced weight and increase strength.

Stack ability

- The modular system allows for the quick and simple erection of a temporary or semi-permanent camp. Perfect for use at mines, construction sites and other places where accommodation is in short supply.
- A double storey structure can easily be created by simple stacking two assembled single units-maximizing the available floor area.

Assembly

The unit can be assembled quickly and easily with a small team.

OPTIONS

- Partitions
- Sanitary fixtures can be added
 - W.C.
 - Shower
 - Lavatory
 - Sink
 - Water Tanks - Septic Tank
 - Water Heater.
- Steel staircase and walkway in case Units
- Ceramic Tiles for wet areas.
- Solar Panels
- Doors and Windows
- Floor Insulation
- Fire Retardant Insulation Panels.
- Decorative finishing

FLAT PACK SAMPLES

Model A: Single Room

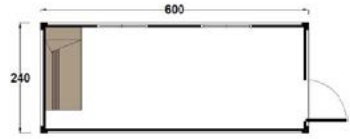

Model B: Twin Room

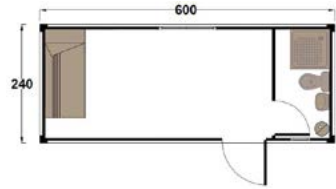

Model C: Single Room with Bathroom

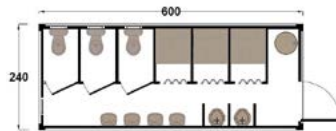
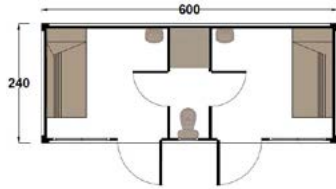

MULTIPROPOSE ACCOMMODATION

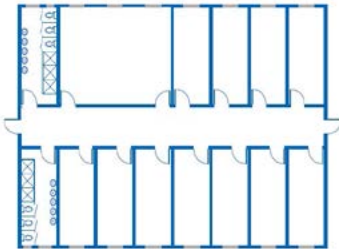

■ Ground Floor

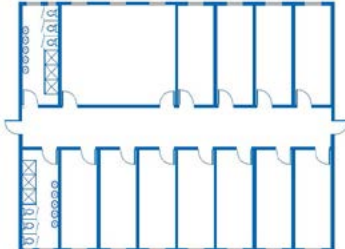

■ First Floor

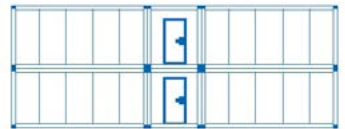

■ Elevation

PACKING



- Packages are prepared by placing temporary short corner beams between top and bottom frames.
- Sizes of packages are (width x length x height) 2400 mm x 6000 mm x 600 mm.
- Each package contains materials to be used for itself.

They are bottom frame, top frame, and 4 corner beams, sandwich wall panels quipped with doors and windows and the required electrical materials.

SHIPPING



Four units are packed together to build a new unit having the sizes of a shipped container

- Shipped by sea: On a vessel
OR
- Shipped by land: On a truck

8 Open Room Units (Size: 6mx2.4m) can fit in a 40ft H.C. Container or on a truck.

INSTALATION



Step 1: Transport the modular stack to the required location



Step 2: Single Modular Unit ready for assembly



Step 3: Lift the roof and reveal the full kit



Step 4: Assemble the corner posts and roof



Step 5: Slide in the panels and connect the wiring



Step 6: Fully Assemble DALAL Modular Unit and ready to use







Reasons why you will love our flat pack modular buildings:

- Insulated office, pre-decorated inside and out.
- Flat pack components can be carried by hand
- Quick and easy to assemble
- Link together and remove wall panels to increase space
- Low maintenance galvanised steel construction
- **Insulated** – 50mm insulation and powder coated finish inside & outside.
- **Man Portable** – No lifting gear or cranes required – each panel can be lifted by hand.
- **Demountable** – Dismantles into flat pack form easily.
- **Modular** – Individual Units can be linked together to form larger office buildings.
- **Complete** – Everything required for assembly is included in the kit. Simple to assemble
- **Quick to build** – Ready for use in 45 minutes.
- **Ready Decorated** – Interior walls and ceilings finished in off white powder coat. Vinyl sheet floor covering.
- **Flexible** – door and window panels can be located in any position.
- **Durable** – manufactured from galvanised steel.



HEAD OFFICE

Furn El Chebak, Tehouita, Dalal Bldg.

P.O. Box 50046, Beirut, Lebanon

tel: +961 1 282 555

mob: +961 3 727 724

fax: +961 1 283 555

email: info@dalalsteel.com



www.dalalsteel.com